

**MagnaClean DualXP®
In-line Magnetic Filter**

MagnaClean DualXP 1 ½" Telescopic

SUBMITTAL DATA *MagnaClean DualXP* – ISSUE DATE 06/2022

Job name	Size
Job location	Quantity
Engineer	Approval
Mechanical contractor	Service
Contractor's P.O. No.	Tag No.
Representative	Notes

Application

In closed loop hydronic heating and chiller systems, the circulation of water contaminants such as copper, chloride, iron, scale, and pH imbalances may result in rapid corrosion, damage, and blockages to components such as ECMs, control valves, thermostats, heat exchangers, heat emitters and pipes, resulting in lower thermal efficiency within the system and even component failures. The MagnaClean DualXP filter provides residential and light commercial system protection using rare-earth neodymium magnets that sit directly in the flow of water, on the return before the boiler, to capture damaging magnetic and non-magnetic debris before they enter the most expensive system component – the heat exchanger.

Delivering market leading dual-filtration performance, direct chemical dosing capability, and improved system efficiencies, the MagnaClean DualXP is an integral part of system maintenance and protection. System maintenance, the use of water treatment and filtration methods are often a requirement of the boiler manufacturer. See their manual and warranty.

Dimensions

MagnaClean DualXP

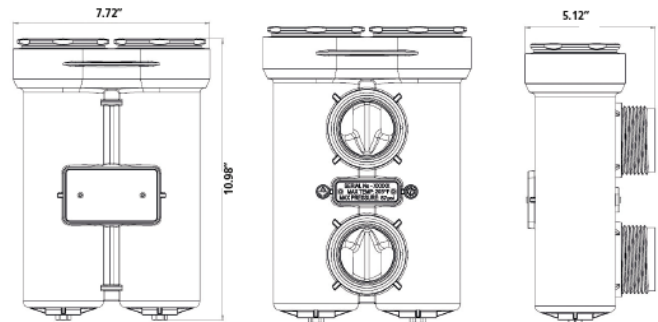

Connectors

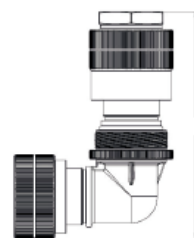

New three-in-one multi-tool

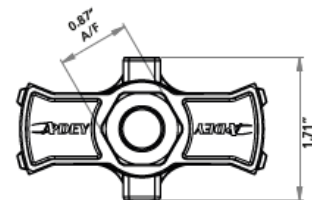

Connections: 1 ½" telescopic

Typical Specification

Furnish and install on the plans and described herein, an ADEY® *MagnaClean DualXP* magnetic filter as manufactured by ADEY. Each filter must be designed with a glass reinforced nylon body with large internal volume, seals in EPDM, two blowdown drain ports, two air vents, two plastic sleeves designed for easy servicing with four non-magnetic debris capture zones, and two large internal powerful, neodymium magnets to capture particles from 50µm to 5µm (0.2 mil), including magnetite.

Each magnetic filter shall be an ADEY MagnaClean DualXP model or approved equal. (See product instructions for specific installation information.)

Pressure Drop Data

Dual XP
Pressure Drop Graph, ft-head vs flow (gpm)

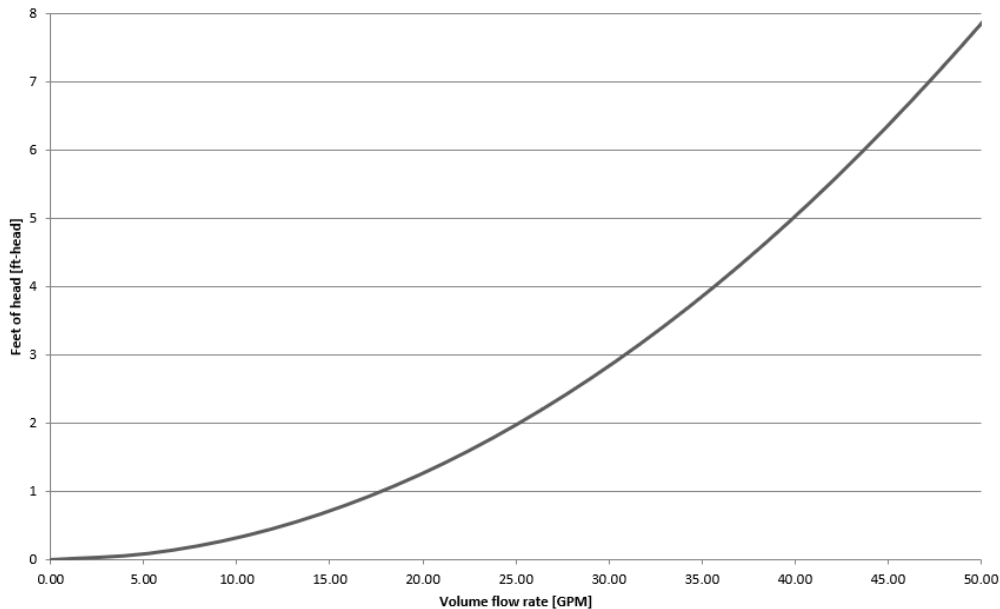
**Technical Data****Canister:**

Filter body & lid: Glass reinforced nylon
Fluid capacity: 0.64 gal / 2.43 litres (when telescopic connectors are retracted)
Inlet diameter: 1" at valve
Outlet diameter: 1" at valve
Thread: Pressure thread
Flow configuration: Bi-directional
Main lid seal: EPDM
Valve to canister: EPDM

Magnet Housing: Stainless steel

Length: 8 7/8"
Diameter: 3/4"

Bleed Valve material: Nickel plated brass
Seals: EPDM

Drain port plug material: Nickel plated brass
Drain plug thread: M8
Seals: EPDM

Telescopic connectors:

Inlet: 1½" Nominal bore
Outlet: 1½" Nominal bore
Body material: Nickel plated brass
Connection: 1½" NPT female
O ring material: EPDM

Servicing clearance

Air vent (top): 2"
Drain Plug (bottom): 2"

Performance

Suitable fluids: water, glycol solution
Max. percentage of glycol: 50%
Max. working pressure: 87 psi (6 bar)
Max. working temperature: 203°F (95°C)
Particle separation capacity: down to 5 µm (0.2 mil)
Flow rate: Up to 50 g/pm
Weight: 18.2 lbs.
Connections - main: 1½" NPT female